

S&N
AIROFLO



**The Source for Floating WWT Equipment
Brush Rotors - Mixers - Polishing RBCs**

OXIDATION DITCHES

AEROBIC DIGESTERS



ACTIVATED SLUDGE BASINS



 products have been utilized in all types of wastewater applications including Activated Sludge Basins, Oxidation Ditches, Aerobic Digesters, EQ Basins, as well as Lagoons.



OXIDATION DITCHES



COLD WEATHER APPLICATIONS



Quick & Simple Installation



From This:



To This:



To This:

All in a matter of hours, not days



Splash Containment Shield SCS (Cold Weather Application)



North Liberty, IN



*Located on Southeastern Tip
Of Lake Michigan*



Orbal Retrofit with Bridge Anchoring System

Franklin, NC

Power Savings: 200 to 135 HP Reduction



before



after



- 200 HP Orbal system
- First rotor installed in 2005, with additional units purchased over the following 18 months
- Over next two years, added eight more units for a total of 135 HP
- Currently operating several units on DO probes, with one or two units rarely operating.



Aerator access attached to bridges



Optional safety harness masts



Bridge Anchoring System with EZ Access and Safety Mast

Heavy Duty Safety Masts with Safety Harness provide extra protection from loss of balance when servicing the aerator

EZ Access Bridge allows workers safe and convenient access for aerator maintenance

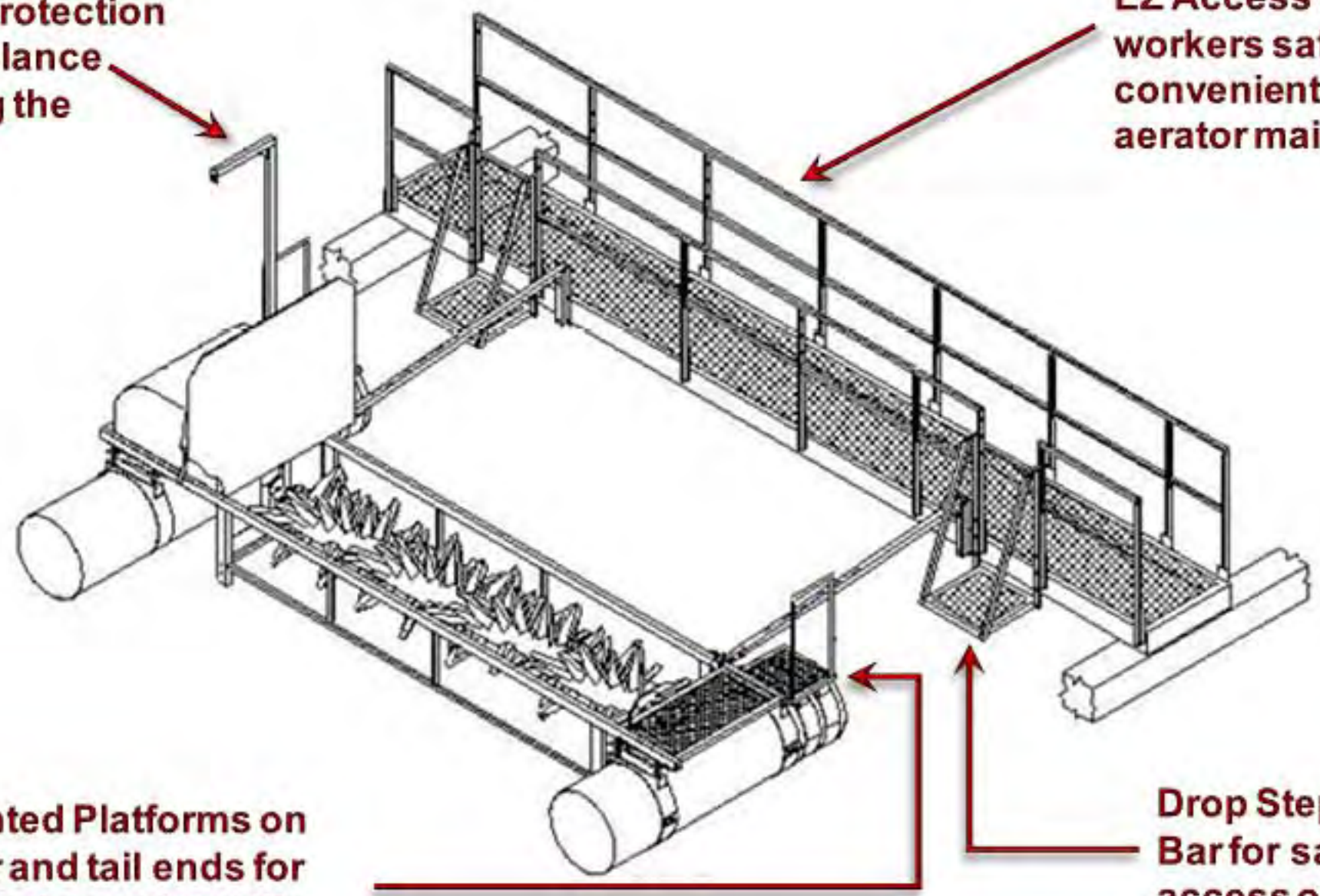

Float Mounted Platforms on both motor and tail ends for easy access to aerator with handrails for added safety

Drop Steps with Stabilizer Bar for safe, convenient access onto the unit

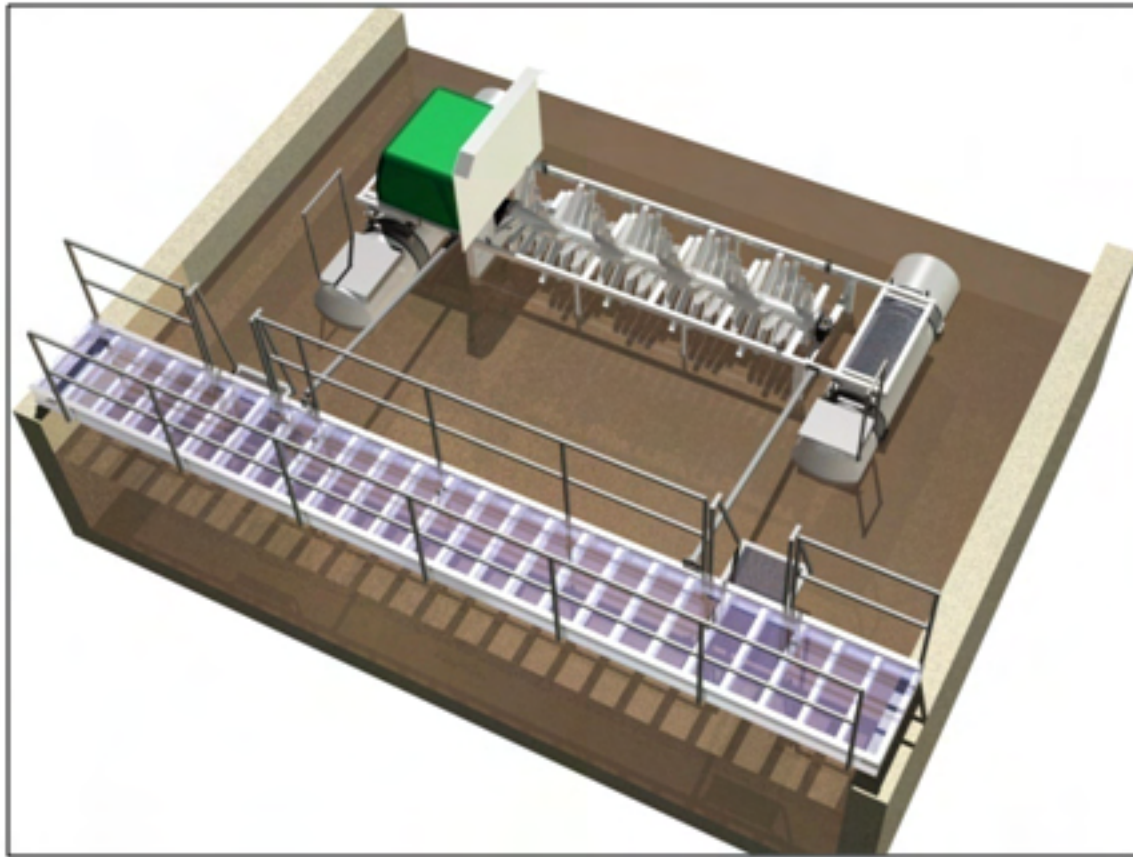

In operating position

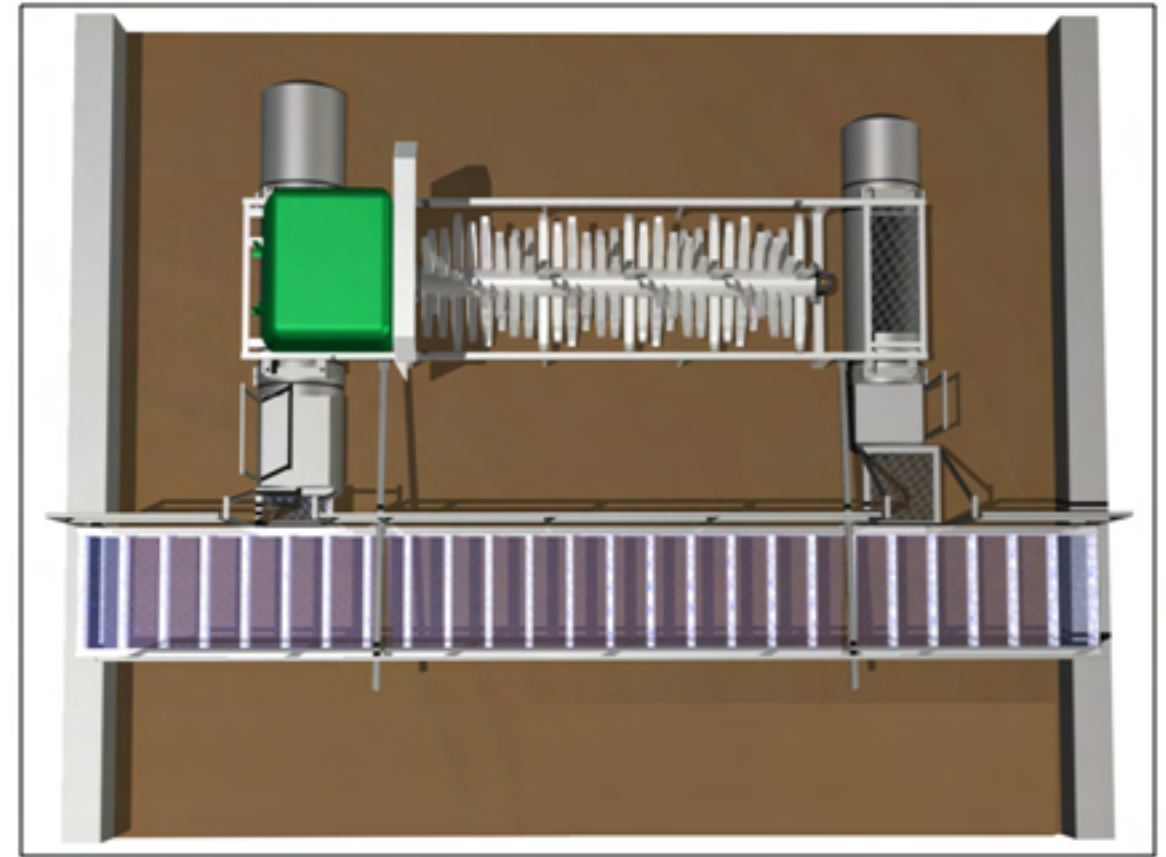

In position for access

Orbal RetroFit with Bridge Anchoring System



- The Extension Connecting Brackets were mounted to the top surface of the existing concrete bridge, enabling quick and easy access.
- Access to the floating brush rotors was made possible through the use of the existing bearing mounting piers.





Bridge & Aerator Installation



Installation is quick and easy

System shut down not required





Cable Anchoring System

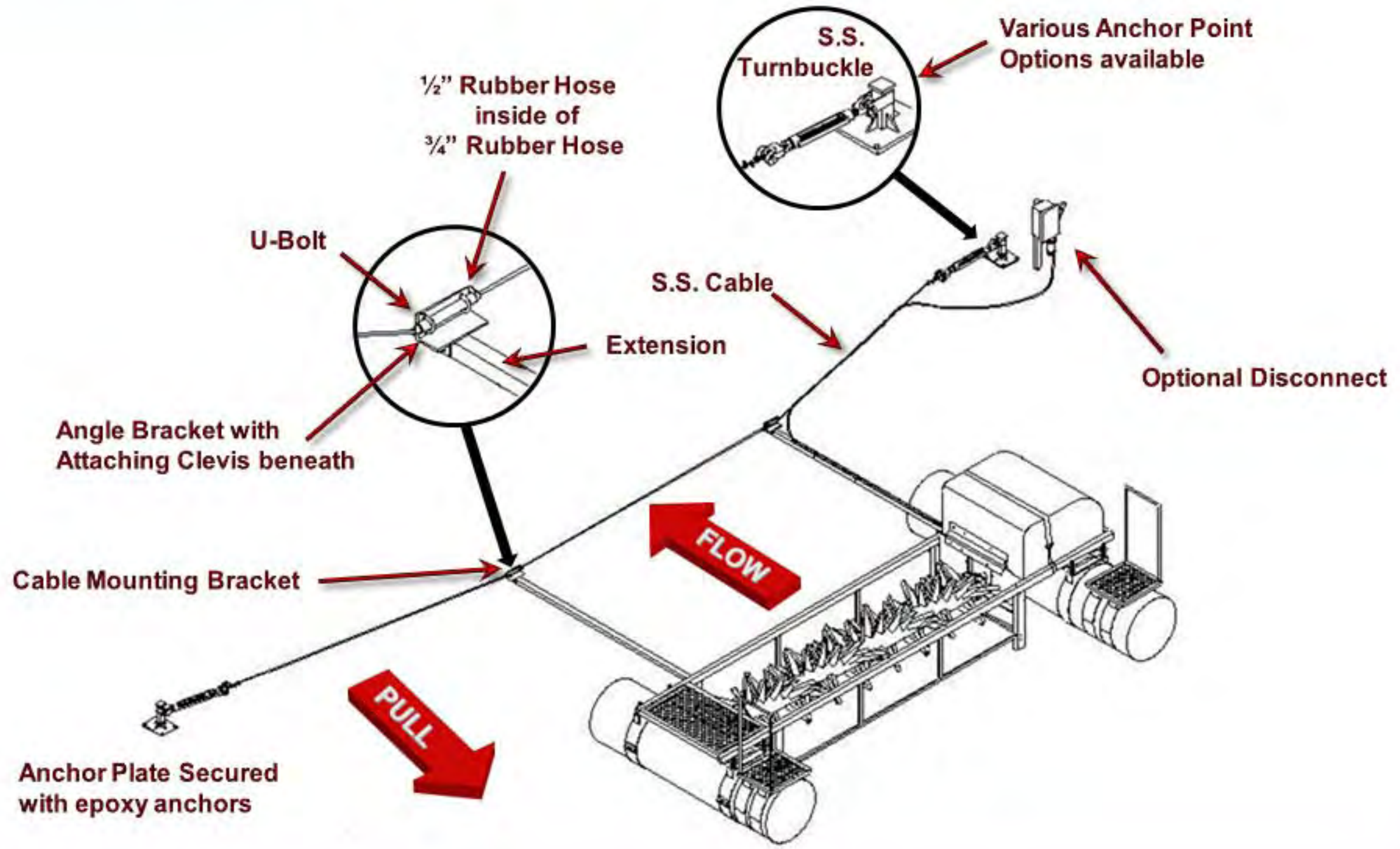

Cable Anchoring System with EZ Access

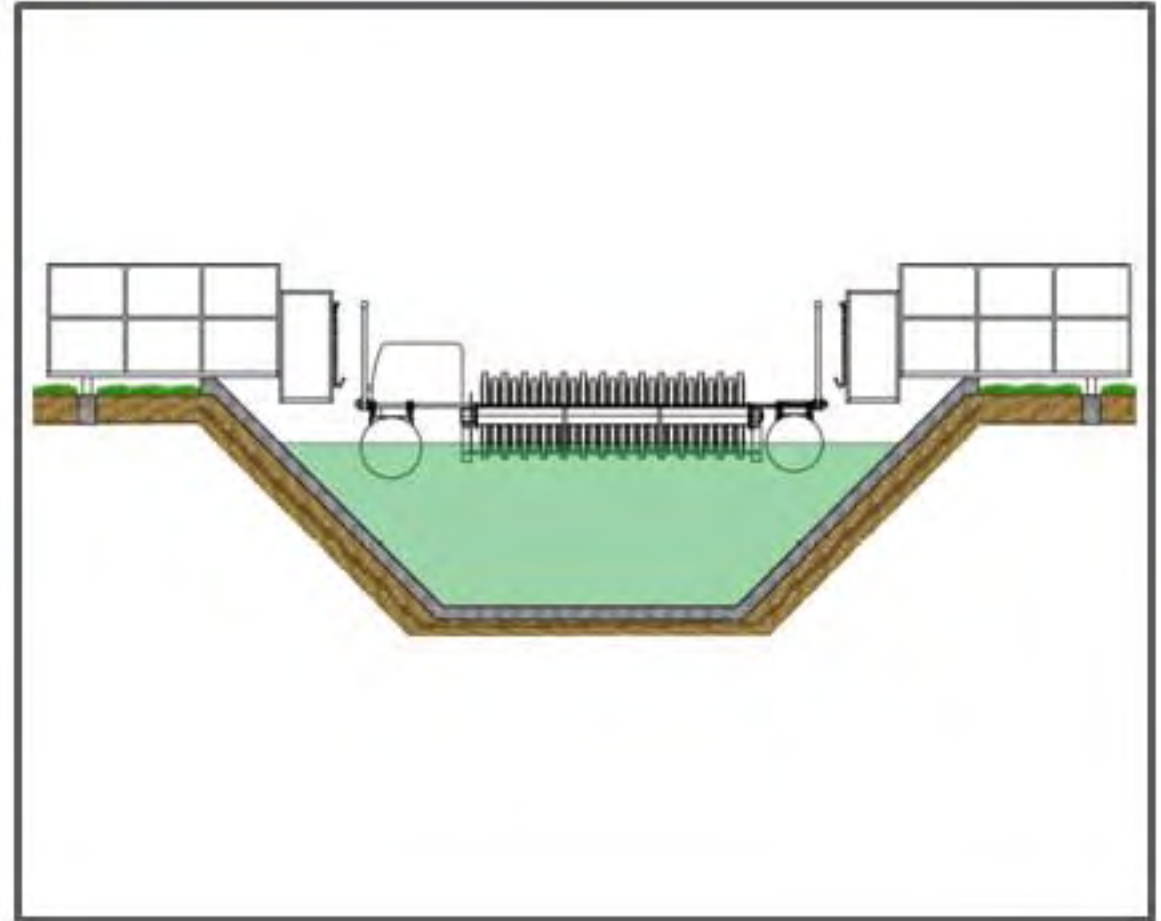
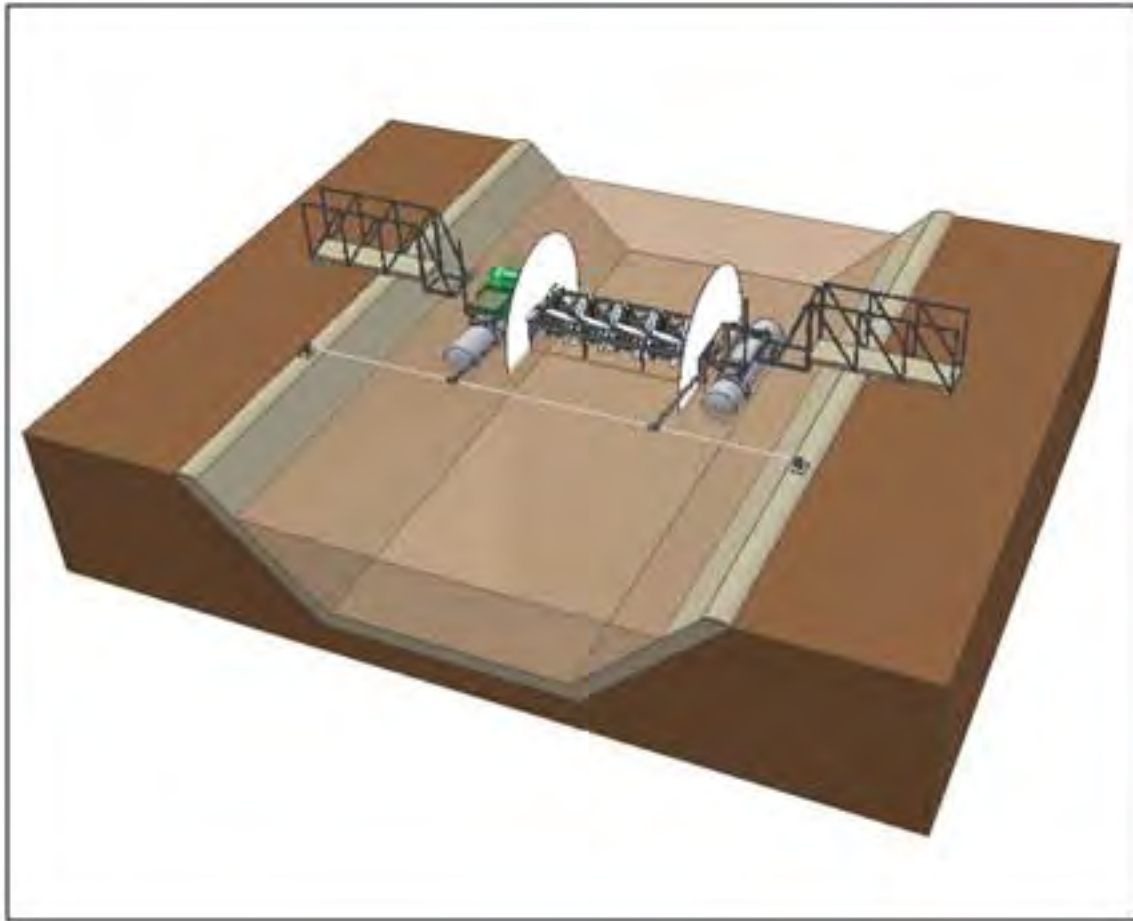

FBR – Cable Mounted

- Ditch flush with ground
- EZ Access from sides
- SCS Splash Containment Shields